

# S-LOK Relief Valves – Spring Kit Replacement Instruction

## SRV30 Series Exploded View

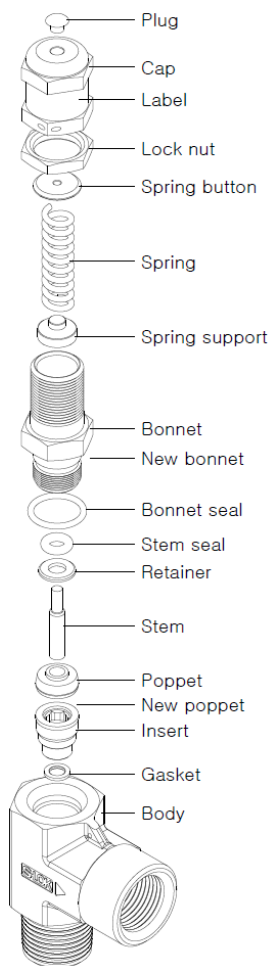

## SRV60 Series Exploded View

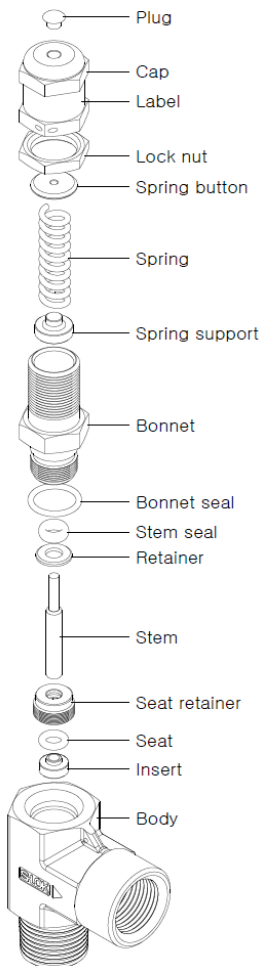

## Spring Kit Part List

No.	Part
1	Spring
2	Label
3	Lock wire with seal

## WARNING !!

**Depressurize system pressure before any valve maintenance.**

## Spring Kit Replacement Instruction

1. Remove the valve from the system.

2. Loosen the cap.

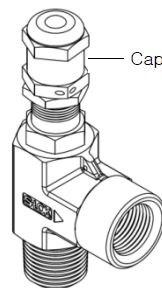

3. Remove the cap, lock nut, spring button, spring, spring support.

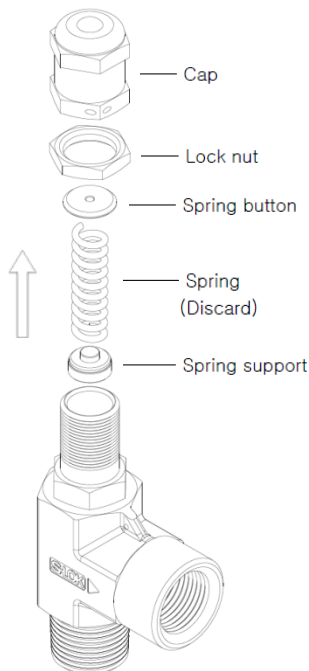

4. Insert the spring support, **new spring**, spring button, lock nut and cap into the body.

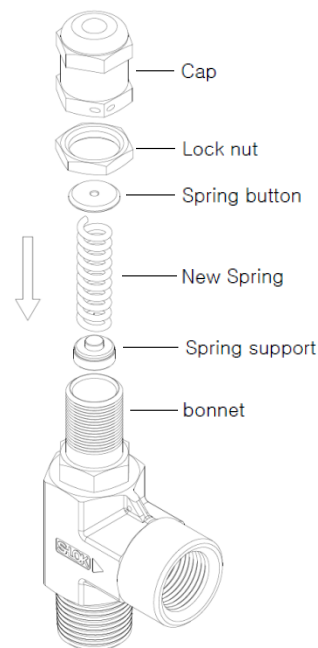

5. Thread the cap onto the bonnet.

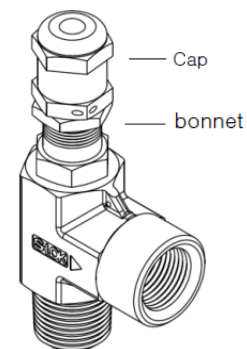

## Cracking Pressure Adjustment

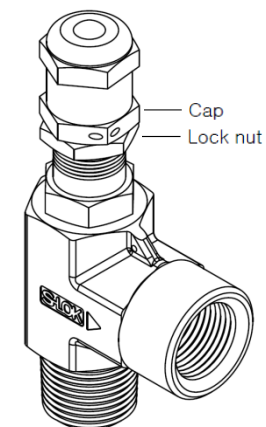

1. Install the valve in the system.

2. Tighten the lock nut against the cap.

3. Tighten the cap onto the bonnet 7 turns.

4. Repeat steps as necessary to obtain desired set pressure.

4-1. To increase cracking pressure, turn the cap clockwise.

4-2. To decrease cracking pressure, turn the cap counter-clockwise.

5. Tighten the lock nut to the cap.

6. Lock wire the cap and body.